

A modern office interior featuring a long wooden conference table with black metal legs and several red plastic chairs. The room has large windows on the left side, providing a view of greenery outside. The ceiling is exposed concrete with visible pipes and ductwork, and two black pendant lamps hang over the table. The floor is a light-colored, polished surface. A blue triangle is visible in the bottom right corner of the image.

**CLICK FLOW**



# CLICK FLOW

## Contents

Lighting Management Boxes .....	<b>28</b>
Flow™ Connectors .....	<b>32</b>
Flow™ Extension Cables .....	<b>38</b>
Ceiling Rose .....	<b>40</b>



Management & Distribution Boxes

CLICK FLOW

WARRANTY  
**IP20**      **20**  
 YEAR

**VISIBLE  
 POWER  
 INDICATOR**



CT1008



SP1016

CODE	DESCRIPTION
CT1008	20A 8 Way Distribution Box
SP1016	Mounting Tray For CT1016 & CT1008

PRODUCT INFO	
Input Voltage (V~)	240
Input Frequency (Hz)	50
Total Output Maximum (A)	20
Operating Temperature Range (°C)	-5 to +40

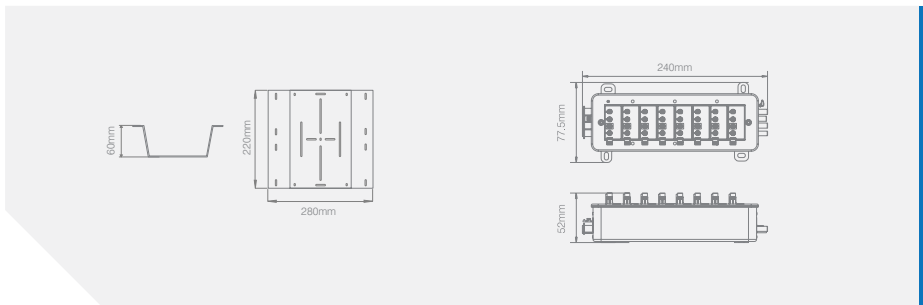

Additional 4 Pole Output Supplied

PRODUCT APPROVALS

BS 8488, BS EN 61535, BS 5733



Management & Distribution Boxes

WARRANTY

**20**  
YEAR

**IP20**

**VISIBLE  
POWER  
INDICATOR**



SP1016



CT1016

PRODUCT INFO

Input Voltage (V~)	240
Input Frequency (Hz)	50
Total Output Maximum (A)	20
Operating Temperature Range (°C)	-5 to +40

CODE DESCRIPTION

CT1016	20A 16 Way Lighting Management Box
SP1016	Mounting Tray For CT1016 & CT1008

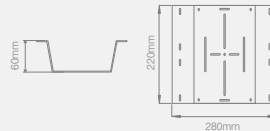
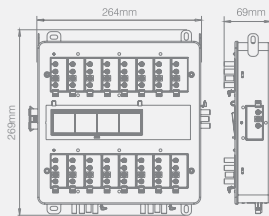

PRODUCT APPROVALS

BS 8488, BS EN 61535, BS 5733

Connector Supplied: 3 Pole (Input), 2 x 4 Pole (Switch Inputs)



Hubs & Splitters

CLICK FLOW

WARRANTY  
**IP20**  
**20**  
 YEAR



CT300



CT350



CT355

CODE	DESCRIPTION
CT300	20A 4 Pole (1 in 3 Out) Flow™ Hub Junction Box
CT350	20A 4 Pole Splitter (1 in 2 Out)
CT355	20A 4 Pole (1 in 2 Out) Compact Splitter

PRODUCT INFO	
Input Voltage (V~)	250
Input Frequency (Hz)	50
Total Output Maximum (A)	20
Operating Temperature Range (°C)	-5 to +40

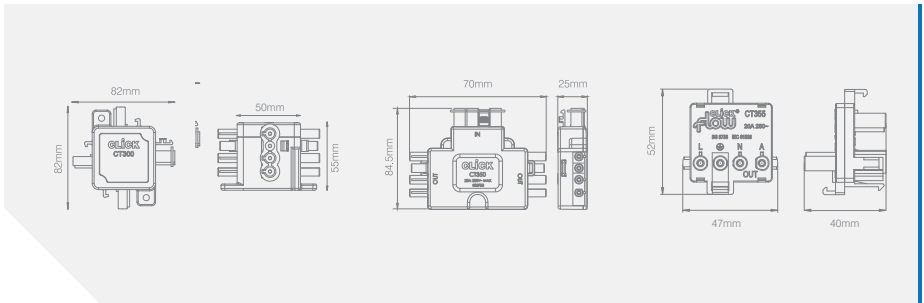

PRODUCT APPROVALS

BS 8488, BS EN 61535, BS 5733



Switch Adaptors

WARRANTY

**20**  
YEAR

**IP20**



CT1300



CT2300

PRODUCT INFO		CODE	DESCRIPTION
Input Voltage (V~)	250	CT1300	20A 3 Pole Switch Adaptor
Input Frequency (Hz)	50	CT2300	20A 4 Pole Switch Adaptor with pre-wired earth and neutral links
Terminal Size (mm)	Ø4.2		
Total Output Maximum (A)	20		
Terminal Capacity - Flex (mm²)	3 x 1.5		
Terminal Capacity - Solid (mm²)	3 x 2.5		
Operating Temperature Range (°C)	-5 to +40		

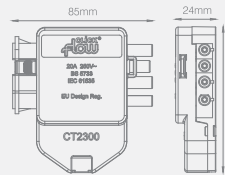
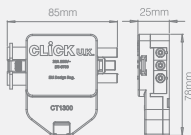

PRODUCT APPROVALS

BS 8488, BS EN 61535, BS 5733



3 Pole Push-Fit Connectors

CLICK FLOW



CT105F

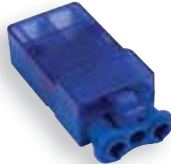

CT105M



CT115F

CODE	DESCRIPTION	PRODUCT INFO
CT105F	20A 3 Pole Female Push-Fit Connector	Input Voltage (V~) 250
CT105M	20A 3 Pole Male Push-Fit Connector	Input Frequency (Hz) 50
CT115F	20A 3 Pole Female Push-Fit Connector With Loop	Rated Impulse Voltage (kV) 4
		Total Output Maximum (A) 20
		Terminal Capacity - Flex (mm <sup>2</sup> ) 2.5 (Max.)
		Terminal Capacity - Solid (mm <sup>2</sup> ) 2.5 (Max.)
		Operating Temperature Range (°C) -5 to +40

**TIME SAVING LEVERS**

Simply push lever down, offer stripped conductor into the terminal & then release the lever, ensuring the cable cannot easily be pulled out.

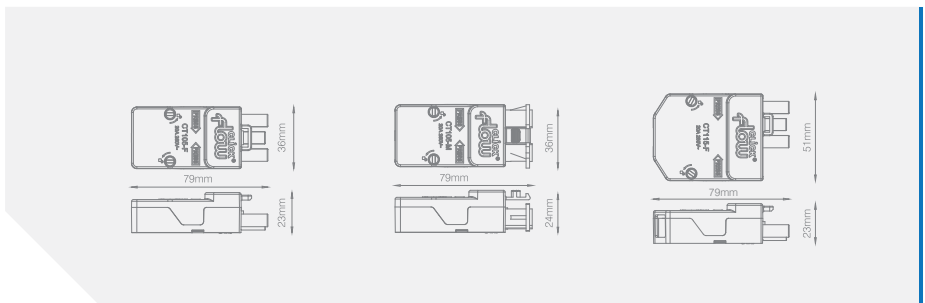

PRODUCT APPROVALS

BS EN 61535





3 Pole Push-Fit Connectors

WARRANTY

20  
YEAR

IP20



CT105C



CT115C

PRODUCT INFO

Input Voltage (V-)	250
Input Frequency (Hz)	50
Rated Impulse Voltage (kV)	4
Total Output Maximum (A)	20
Terminal Capacity - Flex (mm <sup>2</sup> )	2.5 (Max.)
Terminal Capacity - Solid (mm <sup>2</sup> )	2.5 (Max.)
Operating Temperature Range (°C)	-5 to +40

CODE

DESCRIPTION

CT105C	20A 3 Pole Complete Push-Fit Connector (CT105M & CT105F)
CT115C	20A 3 Pole Complete Push-Fit Connector With Loop (CT105M & CT115F)

**TIME SAVING LEVERS**

Simply push lever down, offer stripped conductor into the terminal & then release the lever, ensuring the cable cannot easily be pulled out.

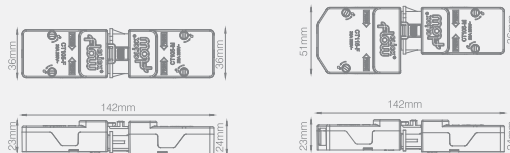

PRODUCT APPROVALS

BS EN 61535



4 Pole Push-Fit Connectors

CLICK FLOW

WARRANTY

**IP20**

**20**  
YEAR



CT205F



CT205M

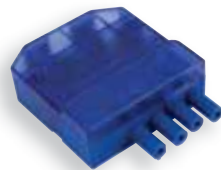

CT215F

CODE	DESCRIPTION
CT205F	20A 4 Pole Female Push-Fit Connector
CT205M	20A 4 Pole Male Push-Fit Connector
CT215F	20A 4 Pole Female Push-Fit Connector With Loop

PRODUCT INFO	
Input Voltage (V~)	250
Input Frequency (Hz)	50
Rated Impulse Voltage (kV)	4
Total Output Maximum (A)	20
Terminal Capacity - Flex (mm <sup>2</sup> )	2.5 (Max.)
Terminal Capacity - Solid (mm <sup>2</sup> )	2.5 (Max.)
Operating Temperature Range (°C)	-5 to +40

**TIME SAVING LEVERS**

Simply push lever down, offer stripped conductor into the terminal & then release the lever, ensuring the cable cannot easily be pulled out.

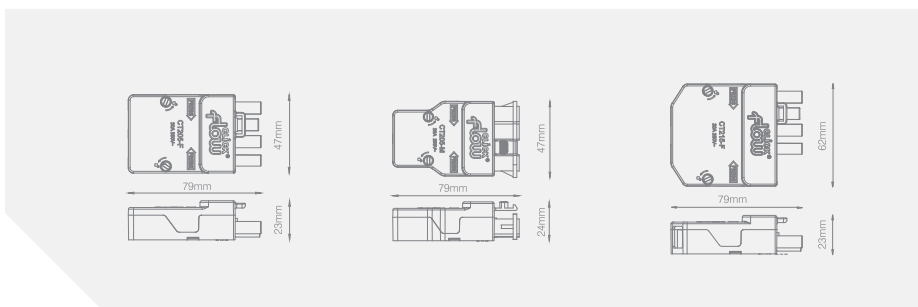

PRODUCT APPROVALS

BS EN 61535



4 Pole Push-Fit Connectors

WARRANTY

20  
YEAR

IP20



CT205C



CT215C

PRODUCT INFO

Input Voltage (V~)	250
Input Frequency (Hz)	50
Rated Impulse Voltage (kV)	4
Total Output Maximum (A)	20
Terminal Capacity - Flex (mm <sup>2</sup> )	2.5 (Max.)
Terminal Capacity - Solid (mm <sup>2</sup> )	2.5 (Max.)
Operating Temperature Range (°C)	-5 to +40

CODE DESCRIPTION

CT205C	20A 4 Pole Complete Push-Fit Connector (CT205M & CT205F)
CT215C	20A 4 Pole Complete Push-Fit Connector With Loop (CT205M & CT215F)

TIME SAVING LEVERS

Simply push lever down, offer stripped conductor into the terminal & then release the lever, ensuring the cable cannot easily be pulled out.

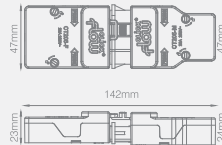
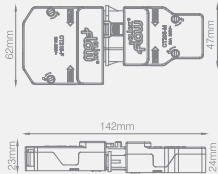

PRODUCT APPROVALS

BS EN 61535



3 Pole Connectors

CLICK FLOW



CODE	DESCRIPTION	PRODUCT INFO
CT101C	20A 3 Pole Connector	Input Voltage (V~) 250
CT102C	20A 3 Pole Connector Screw-Down Cord Grip	Input Frequency (Hz) 50
CT103C	20A 3 Pole Connector Fast-Fit Cord Grip	Rated Impulse Voltage (kV) 4
CT103M	20A 3 Pole Fast-Fit Cord Grip (Male Connector Only)	Terminal Size (mm) Ø4.2
		Total Output Maximum (A) 20
		Terminal Capacity - Flex (mm²) 3 x 1.5
		Terminal Capacity - Solid (mm²) 3 x 2.5
		Operating Temperature Range (°C) -5 to +40

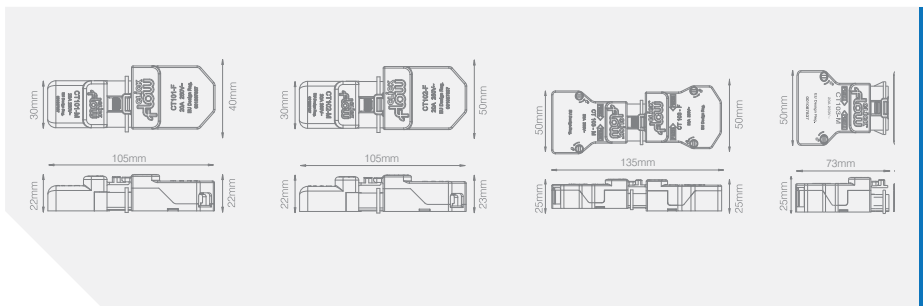

PRODUCT APPROVALS



CT101C: BS 5733  
BS EN 61535, BS 5733

4 Pole Connectors

WARRANTY

20  
YEAR

IP20



PRODUCT INFO

Input Voltage (V~)	250
Input Frequency (Hz)	50
Rated Impulse Voltage (kV)	4
Terminal Size (mm)	Ø4.2
Total Output Maximum (A)	20
Terminal Capacity - Flex (mm <sup>2</sup> )	3 x 1.5
Terminal Capacity - Solid (mm <sup>2</sup> )	3 x 2.5
Operating Temperature Range (°C)	-5 to +40

CODE

DESCRIPTION

CT202C	20A 4 Pole Connector Screw-Down Cord Grip
CT203C	20A 4 Pole Connector Fast-Fit Cord Grip
CT203M	20A 4 Pole Fast-Fit Cord Grip (Male Connector Only)

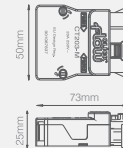
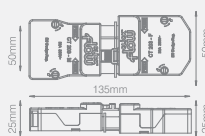
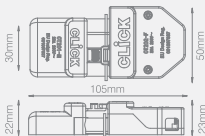

PRODUCT APPROVALS

BS EN 61535, BS 5733



Pre-Wired LSZH Link Cables, Male connectors to F/E

CLICK FLOW



CT845

CODE	DESCRIPTION	PRODUCT INFO								
CT732	6A 3 Pole 0.75mm LSZH To FE 2m - Black	<table border="1"> <tr> <td>Input Voltage (V~)</td> <td>250</td> </tr> <tr> <td>Input Frequency (Hz)</td> <td>50</td> </tr> <tr> <td>Total Output Maximum (A)</td> <td>6 &amp; 20</td> </tr> <tr> <td>Operating Temperature Range (°C)</td> <td>-5 to +40</td> </tr> </table>	Input Voltage (V~)	250	Input Frequency (Hz)	50	Total Output Maximum (A)	6 & 20	Operating Temperature Range (°C)	-5 to +40
Input Voltage (V~)	250									
Input Frequency (Hz)	50									
Total Output Maximum (A)	6 & 20									
Operating Temperature Range (°C)	-5 to +40									
CT733	6A 3 Pole 0.75mm LSZH To FE 3m - Black									
CT735	6A 3 Pole 0.75mm LSZH To FE 5m - Black									
CT742	6A 4 Pole 0.75mm LSZH To FE 2m - Black									
CT743	6A 4 Pole 0.75mm LSZH To FE 3m - Black									
CT745	6A 4 Pole 0.75mm LSZH To FE 5m - Black									
CT845	20A 4 Pole 2.5mm Male To Female LSZH 5m - Black									

PRODUCT APPROVALS

BS EN 61535, BS 5733, BS EN 50525-3-11



Extension Cables

WARRANTY

20  
YEAR

IP20



CLICK FLOW

PRODUCT INFO

Input Voltage (V~)	250
Input Frequency (Hz)	50
Total Output Maximum (A)	6
Operating Temperature Range (°C)	-5 to +40

CODE

DESCRIPTION

CT802	6A 4 Pole PVC Extension Cable - 2 Metre
CT803	6A 4 Pole PVC Extension Cable - 3 Metre
CT805	6A 4 Pole PVC Extension Cable - 5 Metre

PRODUCT APPROVALS

BS EN 61535, BS 5733, BS EN 50525-3-11



Ceiling Rose



CT1400



CT1401

CODE	DESCRIPTION	PRODUCT INFO
CT1400	20A 4 Pole Ceiling Rose (Without Cover)	<b>Input Voltage (V~)</b> 250
CT1401	CT1400 Ceiling Rose Cover	<b>Input Frequency (Hz)</b> 50
CT101C, CT102C, CT202C compatible with rose cover installed		<b>Rated Impulse Voltage (kV)</b> 4
When rose cover installed, not suitable for use with CT103, CT203 or Push Fit Connectors		<b>Terminal Size (mm)</b> Ø4.2
		<b>Total Output Maximum (A)</b> 20
		<b>Terminal Capacity - Flex (mm<sup>2</sup>)</b> 3 x 1.5
		<b>Terminal Capacity - Solid (mm<sup>2</sup>)</b> 3 x 2.5
		<b>Operating Temperature Range (°C)</b> -5 to +40

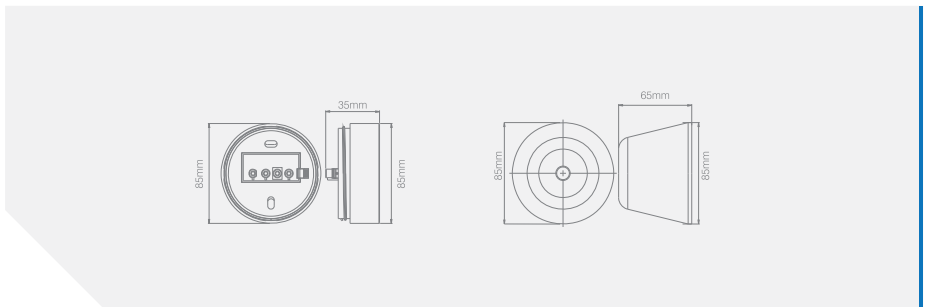

PRODUCT APPROVALS

CT1401: BS 8488, BS EN 61535, BS 5733

